

All Dimensions Are  
In mm Unless Stated

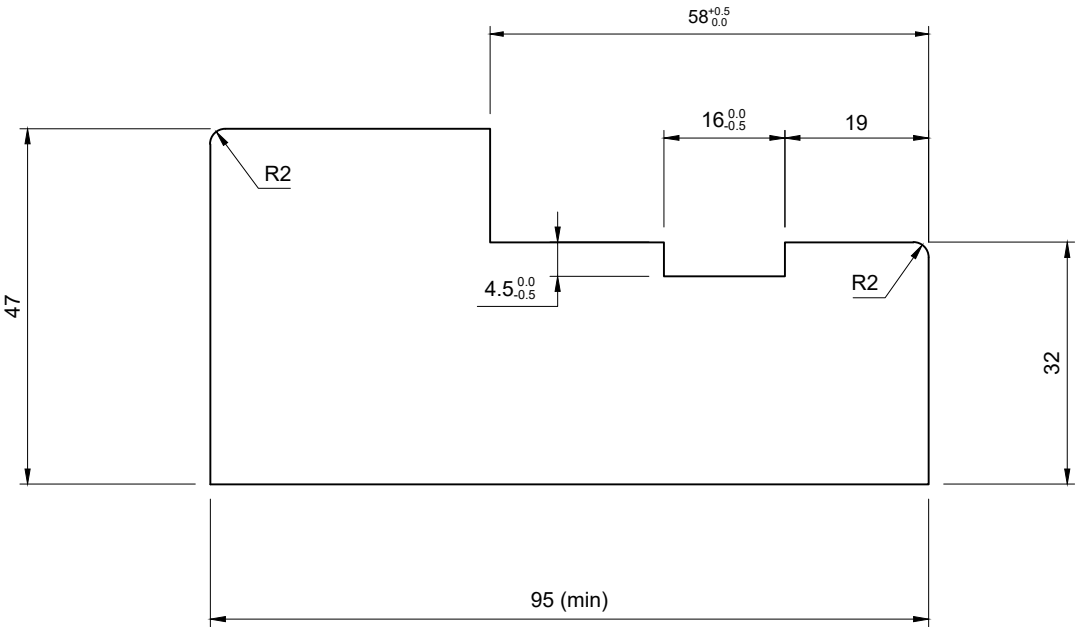

Do Not Scale. If In Doubt Ask!

Description: **Machining Profile 47/32mm PAS24 Single Point Lock - Non Q2F Push - 55mm Door - FD30**

Drawn By: <b>P. Brash</b>	Approved: <b>Approved</b>	Revision:	Date: <b>16/05/2023</b>	Drawing No:	 <b>DP21526</b> Rev00
Size: <b>See Above</b>	Tolerance: <b>+/- 0.5mm</b>		Fire Rating:		
Job No:	© Doorpac Ltd		<b>FD30S</b>		